

Designed to provide efficient power distribution in a rugged compact form with applications in marine, construction, agriculture, heavy trucking, and specialty vehicle industries. It accommodates a combination of up to 40 x Mini fuse or Mini Blade Breakers and 10 x ISO 280 Micro relays. Also features a slot to hold a fuse puller and 4 slots for spare fuses. Optional common bussing for fuses.

Voltage Rating: 32VDC

Ampere Rating: 200A max.

Components: Accepts Mini fuses, Mini bladed circuit breakers and ISO 280 Micro relays.

All components must have 2.8mm blades on 8.1mm centerline spacing.

Mounting: Threaded inserts # 10-32 as standard (M5 optional).

Intended for horizontal to vertical mounting orientations.

Block & Cover: Black UL-Rated 94V0 thermoplastic. Silicone rubber gasket. Deep cover with internal tether. Cover included with base.

Cover Options: Replacement covers also available.

Deep cover only (fuses / relays / circuit breakers) # B151-7182-1.

Internal Buss: Plated copper (optional, feeds fuses only)

Input Studs: M8 x 1.25 stud (on bussed versions).

Input Stud Rating: 100A max per bus bar

Output Terminal Rating: 30A max per terminal.

Ingress Protection Rating: IP66 (Valid when properly installed with cover, cable seals and cavity plugs).

Wire Size: #22 - # 12 AWG / 0.35mm² - 3mm²

Temperature Rating: -40°C to +85°C (Module only)

Terminals: Tanged Female Sealed Tin Brass / Tin Plated

Cavity Plugs: Required to fill unused output cavities for ingress protection.

Cable Seals: Please check the overall diameter of your cable before ordering cable seals.

Terminal Tools: Terminal crimping & removal tools see page 144.

Ordering: Block is supplied with cover & one nut for each input stud.

Pack Size: 1pc, 20pcs, 100pcs.

Not Included: Terminals, cable seals, cavity plugs, mounting brackets or mounting screws.

Module does not include any plug-in components such as fuses, circuit breakers, relays or the fuse puller.

**40 x Mini Fuses or Mini Breakers
and 10 x ISO 280 Micro Relays.**



MODULE &

COVER:

Part Number	Mini Fuse Positions*	Fuse Bussing	Left Fuse Side	Right Fuse Side	Relay Contents	Nbr of Cavities	Max Nbr of Terminals
15401-1-2-1-0A	40x Mini Fuses	Dual	Bussed	Bussed	10x ISO 280 Micro	130	90
15402-1-2-1-0A	40x Mini Fuses	Single	Bussed	Unbussed	10x ISO 280 Micro	130	110
15404-1-0-1-0A	40x Mini Fuses	No Bus	Unbussed	Unbussed	10x ISO 280 Micro	130	130

Notes: * Mini circuit breakers can be fitted in mini fuse positions. Relays are un-bussed.

ACCESSORIES:

Part Number	Description
12084201	Terminal Female (#22-20AWG), 0.35 - 0.5mm ²
12077411	Terminal Female (#18-16AWG), 0.80 - 1.0mm ²
12129493	Terminal Female (#14-12AWG), 2.0 - 3.0mm ²
12077413	Terminal Female (#10AWG), 5.0mm ²
15324983	Cable Seal Dark Red, 1.70 - 1.29mm Cable Diameter.
15324982	Cable Seal Green, 2.85 - 2.03mm Cable Diameter.
15324980	Cable Seal Grey, 3.49 - 2.81mm Cable Diameter.
15324981	Cable Seal Blue, 4.30 - 3.45mm Cable Diameter.
12010300	Cavity Plug Green, 6.7mm Cavity inside Diameter.
TERMKIT003	Terminal MP280 Tanged, Seal & Plug Assortment Kit 310pcs
CAB2.0X85TS1TJ	Red Jumper Cable 1.84mm ² x 90mm. Tanged (1pc).
PROBRK003	Bracket Stainless Steel, Black Powder Coated, 90° Angle.
B151-7182-1	Replacement Cover. Black Thermoplastic With Seal.
32013BS	Mini Fuse & Mini Circuit Breaker Puller.



**Mounting Bracket
PROBRK003**



**Terminal Kit
TERMKIT003**



MINI FUSE & MICRO RELAY SEALED MODULE CONTINUED

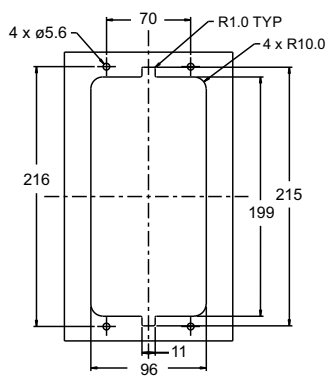
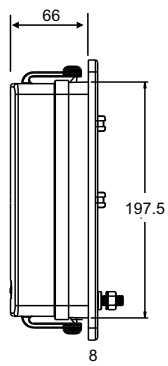
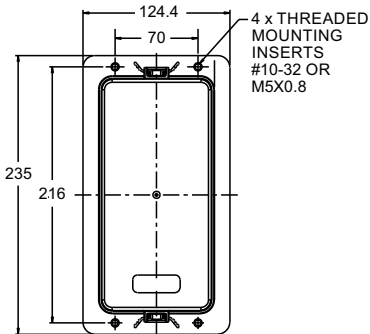

Panel Cutout Diagram
(Mount from the rear of the panel)

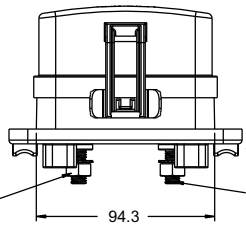
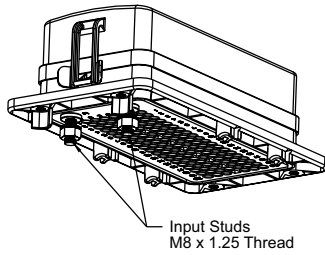

Cable Managers - Options shown on this drawing only

Dimensions in MM

Input Stud Power Diagram

Rear View - Inputs / Outputs

Front View - Component Loading

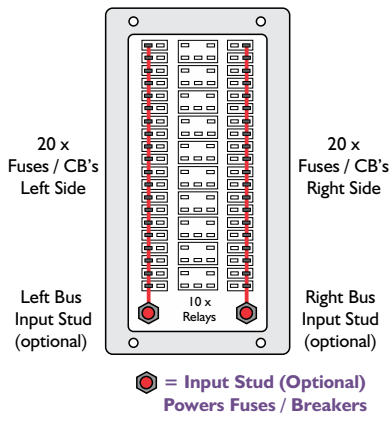

RELATED PRODUCTS:



Mini Fuses, Mini Resistors, Mini Transistors & Mini Blade Circuit Breakers.



ISO 280 Micro Relays 4 or 5 Pin.



Tanged Pre-Terminated Cables & Jumpers, Butt Splice Connectors. Contact sales for further information.