

MINI FUSE / MINI BREAKER IN-LINE HOLDERS SPLASH PROOF

Littelfuse / Bussmann

| Part Number | Description |
|-------------|--|
| FHM001 | 20A with splash proof fuse cover. (IP67) |
| FHM001 CLR | 20A with splash proof fuse clear cover. (IP66) |
| FHM002 | 30A with splash proof fuse cover. (IP67) |
| FHMB001B | 20A with tall circuit breaker cover. |
| FHMB002B | 30A with tall circuit breaker cover. |

IPXX



FHM001 / FHM002



FHM001 CLR
Suits LED Indicating Mini Blade Fuses

Voltage: 32V

Wire: 2.1mm² # 14AWG stranded black wire (FHM001)
1.0mm² # 16AWG stranded red wire (FHM001 CLR)
2.1mm² # 14AWG stranded red wire (FHMB001B)
3.1mm² # 12AWG stranded red wire (FHMB002B)
3.3mm² # 12AWG stranded orange wire (FHM002)

Wire Length: 94mm each side of the body (FHM001 / 2 / 1 CLR)
305mm each side of the body (FHMB001B / 2B)

Body: Black UL 94-V0 heat resistant thermoplastic (FHM001 / 2)

Body: Transparent thermoplastic (FHM001 CLR)

Ambient Temp: -10°C to +80°C

Pack Size: 1, 10, 100, 1000

Note: Fuses & circuit breakers are not included.

Approvals: [RoHS](#)



Spare Pack (SP):

Contains 1 fuse holder.

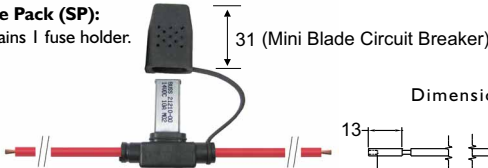

FHMB001B / FHMB002B

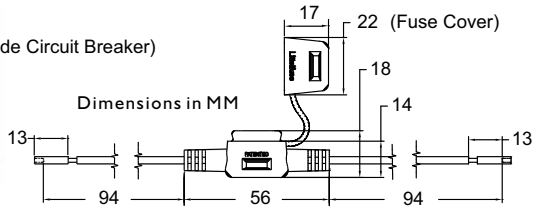

FHM001 / FHM002

MINI FUSE IN-LINE HOLDER

MTA

| Part Number | Description | Pack Size |
|-------------|--|-----------|
| 50152K | Fuse holder kit includes; 01400, 00395, 2 x 07212BK | 1 |

| | | |
|---------|---|---------|
| 01400 | Fuse holder body | 10, 100 |
| 07209BK | Terminal, 0.5 - 1mm ² 10A (BK) | 20, 200 |
| 07212BK | Terminal, 1.5 - 2.5mm ² 14A (BK) | 20, 200 |
| 00395 | Snap mount fixing plate | 10, 100 |

Voltage: 32V

Body: Polyamide 6.6 (PA66)

Terminal Option: BK = Bulk Pack.

Features: Gangable, lateral or snap mount fixing.

Notes: Fuse is not included.

Approvals: [RoHS](#)

Snap Mount Fixing Plate

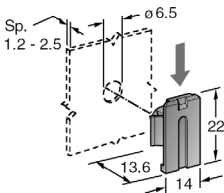

Lateral Fixing

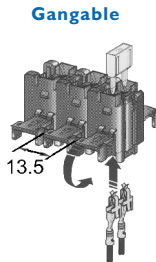
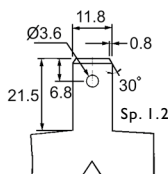

Gangable

Mini Fuse

Fuse Holder Body

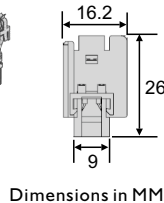

Dimensions in MM

